

Part Number	Size	Deg	R	O	H	S Min	B Min	L
50305	1/2"	30°	4	0.536	2	15	15	2.094
50308	3/4"	30°	4.5	0.603	2.25	15	15	2.356
50310	1"	30°	5.75	0.770	2.875	18.75	15	3.011
50312	1 1/4"	30°	7.25	0.971	3.625	2	2.0	3.796
50315	1 1/2"	30°	8.25	1.105	4.125	2	1.375	4.320
50320	2"	30°	9.25	1.239	4.625	2	1.75	4.843
50325	2 1/2"	30°	10.5	1.407	5.25	3	3.0	5.498
50330	3"	30°	13	1.742	6.5	3.125	2.875	6.807
50335	3 1/2"	30°	15	2.010	7.5	3.25	3.125	7.854
50340	4"	30°	16	2.144	8	3.375	3.375	8.378
50350	5"	30°	24	3.215	12	3.625	4	12.566
50360	6"	30°	30	4.019	15	3.75	5	15.708

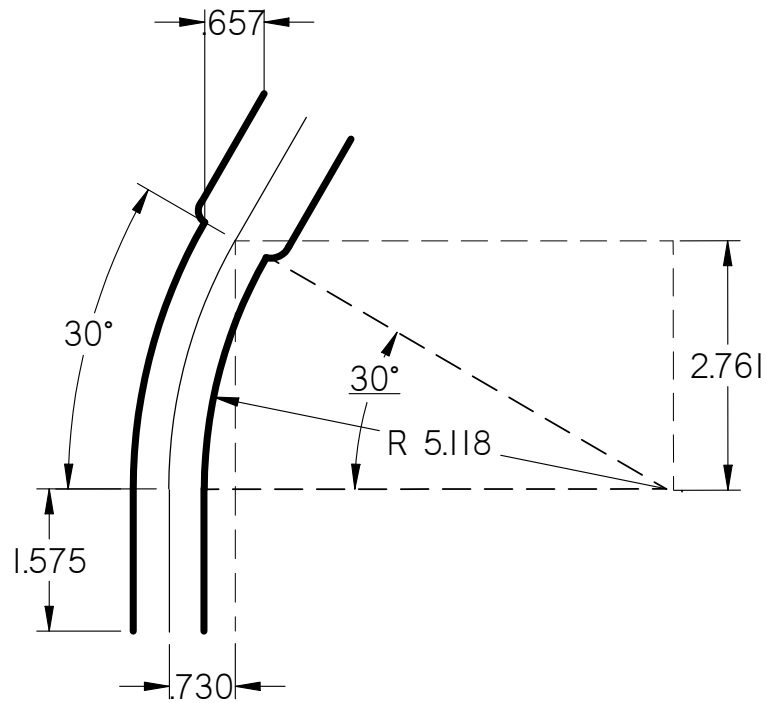

UL Listed 651
 NEMA TC3
 See NEC Article 352 for Usage

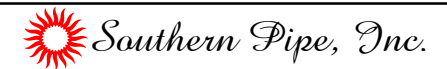

30° Elbows Belled End Schedule 80 Standard Radius

UNLESS OTHERWISE SPECIFIED
 DIMENSIONS ARE IN INCHES
 ANGLES ±2.0°

	NAME	DATE
DRAWN	K. Mitchell	04/01/13
CHECKED		
ENG APPR		
FILE: 30 DEG SCH 80 STD RAD BE.dft REV 10		