

Part Number	Size	Deg	R	O	H	S Min	B Min	L
63020	2"	45°	24	17	7	2"	1.75	18.875
63030	3"	45°	24	17	7	3.125"	2.875	18.875
63040	4"	45°	24	17	7	3.375"	3.375	18.875

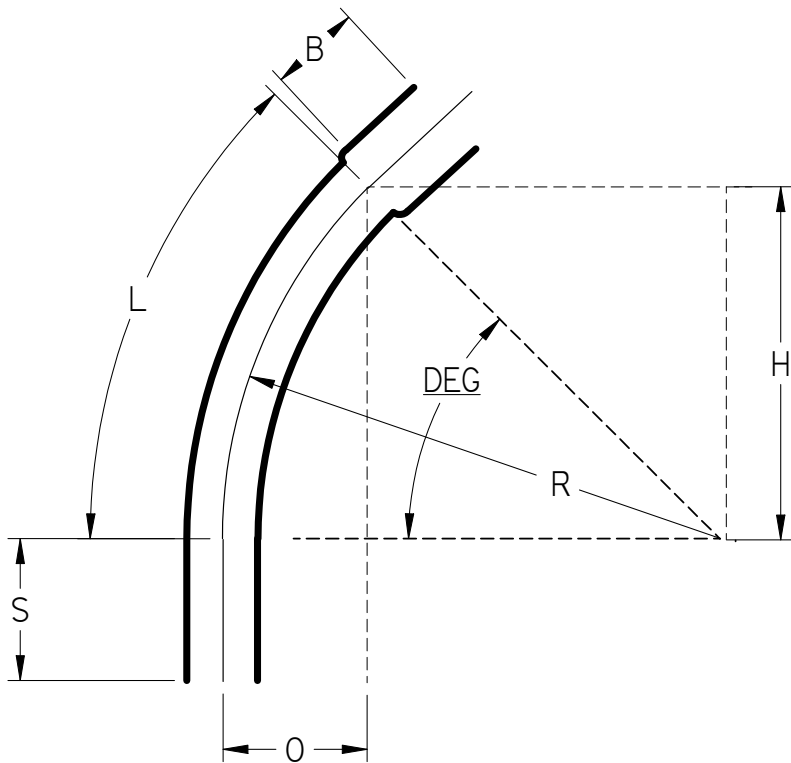

NEMA TC 6
 NEMA TC 3
 See NEC Article 352 for Usage



45° Elbows Belled End TC 6 DB-60 24" Radius

UNLESS OTHERWISE SPECIFIED
 DIMENSIONS ARE IN INCHES
 ANGLES ±2.0°

	NAME	DATE
DRAWN	K. Mitchell	04/01/13
CHECKED		
ENG APPR		
FILE: 45 DEG TC 6 DB-60 24 RAD.dwg		REV 10